



ET 338

Elite Tweeter, Ø 110mm, 8Ω



Features:

- * 110mm IDR™ Improved Dispersion Recess design aluminum face plate
- * Large Hexatech™ aluminum voice coil
- * Replaceable Acuflex™ dome / coil assembly
- * Triple magnet system
- * High power handling
- * Sturdy gold plated input tags

SPECIFICATIONS

General Data

Overall Dimensions	DxH	110mm(4.09")x66mm(2.59")
Nominal Power Handling (DIN)	P	200W
Transient Power 10ms		1000W
Sensitivity 1W/1M		92.5dB SPL
Frequency Response		1,800-20,000 Hz
Cone/Dome Material		Acuflex™ hand coated soft dome
Net Weight	Kg	1.08

Electrical Data

Nominal Impedance	Z	8Ω
DC Resistance	Re	5.2Ω
Voice Coil Inductance @ 1KHz	LBM	0.09mH

Voice Coil and Magnet Parameters

Voice Coil Diameter	DIA	28mm
Voice Coil Height		2.7mm
HE Magnetic Gap Height	HE	2.5mm
Max. Linear Excursion	X	
Voice Coil Former		Aluminum
Voice Coil Wire		Hexatech™ Aluminum
Number Of Layers		2
Magnet System Type		Triple Ferrite
B Flux Density	B	1.95 T
BL Product	BXL	6.3 N.A

T-S Parameters

Suspension Compliance	Cms	
Mechanical Q Factor	Qms	
Electrical Q Factor	Qes	
Total Q Factor	Qts	
Mechanical Resistance	Rms	
Moving Mass	Mms	0.44 g
Eq. Cas Air Load (liters)	VAS	
Resonant Frequency	Fs	700 Hz 10%
Effective Piston Area	SD	6.0 cm ²

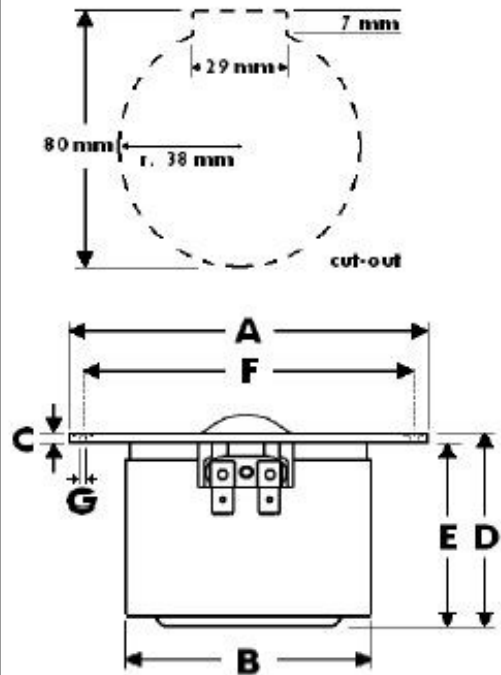

A - Overall diameter	110mm
B - Magnet/Chamber diameter	76mm
C - Flange thickness	3mm
D - Overall height	66mm
E - Magnet/Chamber depth	63mm
F - Mounting holes location diameter	100mm
G - 6 Mounting holes, at 60° interval, inner hole diameter pocket	Ø 3.7mm h 1mm, Ø 7mm

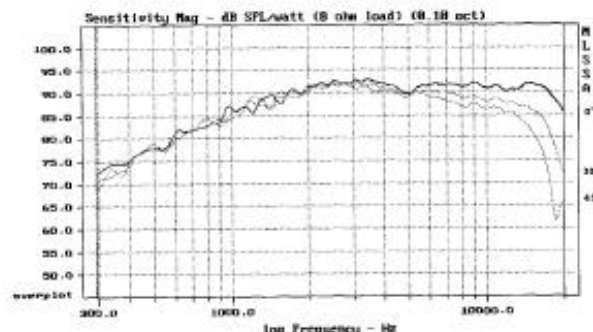
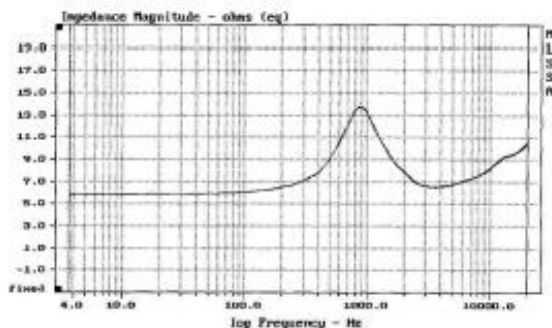

This model replaces former Morel MDT-33 model.

Morel operate policy of continuous product design improvement, consequently specifications are subject to alteration without prior notice.