

Peerless 1" DOME TWEETER

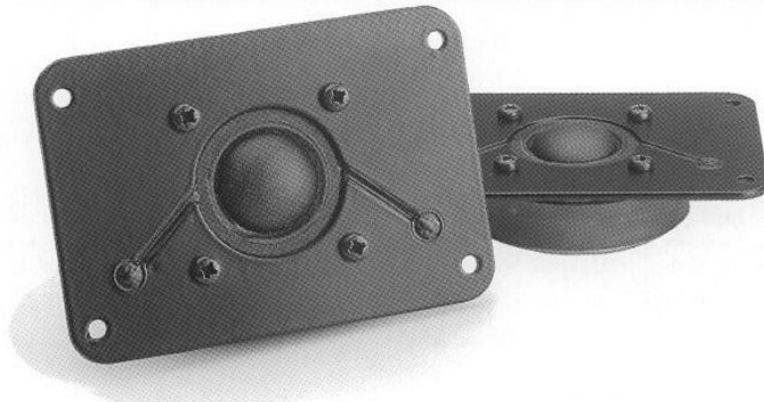

810665

115 DT 26 72 SF 8Ω

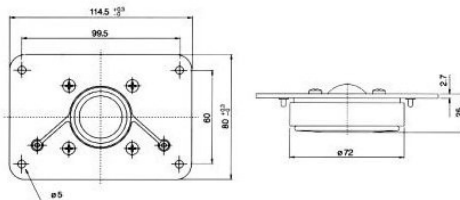

An "evergreen" among dome tweeters with aluminium flange. This famous unit has been on the market for several years. By experts all over the world it has gained a reputation as being one of the best tweeters. This is proved by its use in studio monitors by broadcasting stations and in high-end loudspeaker boxes.

Thiele Small parameters:			Magnet and voice coil parameters:		
Nominal impedance	Znom (Ω):	8.0	Voice coil diameter d (mm):	26	
Minimum impedance/at freq.	Zmin (Ω/Hz):	6.3/490	Voice coil length h (mm):	1.6	
Maximum impedance	Zo (Ω):	31.9	Voice coil layers n	2	
Dc resistance	Re (Ω):	6.8	Flux density in gap B (T):	1.5	
Voice coil inductance	Le (mH):	0.1	Total useful flux Φ (mWb):	0.3	
Resonance frequency	fs (Hz):	1056	Height of the gap hg (mm):	3.0	
Mechanical Q factor	Qms	4.16	Diameter of magnet dm (mm):	72	
Electrical Q factor	Qes	1.13	Height of magnet hm (mm):	15	
Total Q factor	Qts	0.89	Weight of magnet (kg):	0.24	
Mechanical resistance	Rms (kg/s):	0.38			
Moving mass	Mms (g):	0.24	Power handling:		
Suspension compliance	Cms (mm/N):	0.10	Longterm Max System Power (IEC) (W):	80	
Effective cone diameter	D (cm):	2.8	Max linear SPL (rms)/by power (dB/W):	103/25	
Effective piston area	Sd (cm²):	6.2	Frequency range for test signal:	3500-20000 Hz	
Force factor	BL (N/A):	3.1			
Reference Voltage Sensitivity Re 2.83V 1m at 490 Hz	(dB):	91.5			

Normal programme material signal with a crest factor of 6dB (IEC 268-5) is used in both tests

