

80 DT 26 55 SF 4Ω

811581

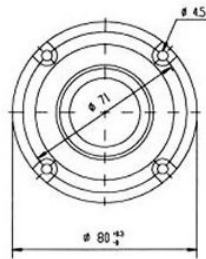

Small competitively priced dome tweeter for cars with an 80 mm face plate. This tweeter is identical to the 811582 except for the 4Ω impedance. The small size makes it suitable for use in car stereo systems. A pair of these units can be mounted in the front panel to enhance stereo, however, it is furthermore to be used as part of speaker systems in the doors or for parcel shelf mounting.

**Thiele Small parameters:**

Nominal impedance	Zn (Ω)	4
Minimum impedance/at freq.	Zmin (Ω/Hz)	3.9 / 2200
Maximum impedance	Zo (Ω)	11.5
Dc resistance	Re (Ω)	3.7
Voice coil inductance	Le (mH)	0.1
Resonance Frequency	fs (Hz)	1070
Mechanical Q factor	Qms	6.69
Electrical Q factor	Qes	3.17
Total Q factor	Qts	2.15
Mechanical resistance	Rms (Kg/s)	0.30
Moving mass	Mms (g)	0.30
Suspension compliance	Cms (mm/N)	0.07
Effective cone diameter	D (cm)	2.8
Effective piston area	Sd (cm <sup>2</sup> )	6.2
Force factor	Bl (N/A)	1.5
Reference voltage sensitivity	(dB)	90
Re 2.83V 1m at 2200 Hz (Measured)		

**Magnet and voice coil parameters:**

Voice coil diameter	d (mm)	26
Voice coil length	h (mm)	1.3
Voice coil layers	n	2
Flux density in gap	B (T)	1.0
Total useful flux	(mWb)	0.2
Height of the gap	hg (mm)	2.5
Diameter of magnet	dm (mm)	55
Height of magnet	hm (mm)	8
Weight of magnet	(kg)	0.07

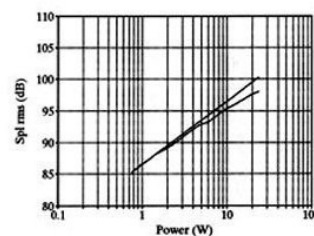
**Max linear SPL:****Power handling**

Longterm Max System Power (IEC) (W)

