

100 DT 26 72 SF WA 8Ω

811815

A 1" dome tweeter with "wide angle" face plate. A remarkable feature of this 1" dome tweeter is its "controlled directivity". A general problem for tweeters is too much directivity in the high end and unwanted omnidirectionality in the low end. This new concept in dome tweeters has proved to give distinguished musical qualities. We highly recommend this unit for any demanding hi-fi construction.

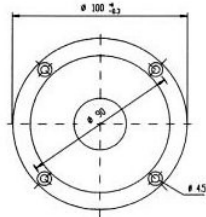

DT 100

Thiele Small parameters:

Nominal impedance	Zn (Ω)	8
Minimum impedance/at freq.	Zmin (Ω/Hz)	5.9 / 3100
Maximum impedance	Zo (Ω)	30.5
Dc resistance	Re (Ω)	5.5
Voice coil inductance	Le (mH)	0.1
Resonance Frequency	fs (Hz)	860
Mechanical Q factor	Qms	4.31
Electrical Q factor	Qes	0.94
Total Q factor	Qts	0.77
Mechanical resistance	Rms (Kg/s)	0.48
Moving mass	Mms (g)	0.38
Suspension compliance	Cms (mm/N)	0.09
Effective cone diameter	D (cm)	2.8
Effective piston area	Sd (cm ²)	6.2
Force factor	Bl (N/A)	3.5
Reference voltage sensitivity	(dB)	92
Re 2.83V 1m at 3100 Hz	(Measured)	

Magnet and voice coil parameters:

Voice coil diameter	d (mm)	26
Voice coil length	h (mm)	1.8
Voice coil layers	n	2
Flux density in gap	B (T)	1.5
Total useful flux	(mWb)	0.3
Height of the gap	hg (mm)	2.5
Diameter of magnet	dm (mm)	72
Height of magnet	hm (mm)	15
Weight of magnet	(kg)	0.24

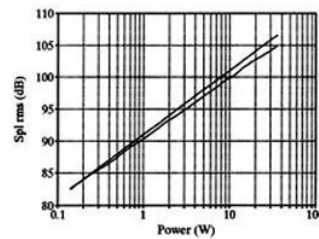
Max linear SPL:**Power handling**

Longterm Max System Power (IEC) (W) 100

