

Peerless



2" MIDRANGE



821214

134 DM 51 100 SF 8Ω

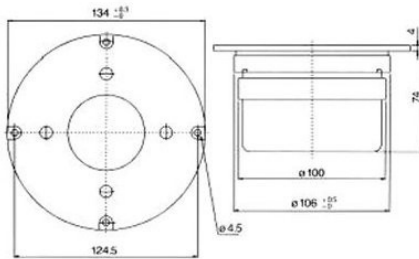

A 51mm dome midrange with soft fabric dome. The very special face plate with the dome placed in a cylindrical aperture forming an acoustic lens provides excellent dispersion characteristics. Typically to be used in three-way hi-fi systems.

Thiele Small parameters:

Nominal impedance	Znom (Ω):	8.0
Minimum impedance/at freq.	Zmin (Ω/Hz):	8.3/1092
Maximum impedance	Zo (Ω):	23.9
Dc resistance	Re (Ω):	7.2
Voice coil inductance	Le (mH):	0.3
Resonance frequency	fs (Hz):	298
Mechanical Q factor	Qms :	2.14
Electrical Q factor	Qes :	0.93
Total Q factor	Qts :	0.65
Mechanical resistance	Rms (kg/s):	2.37
Moving mass	Mms (g):	2.71
Suspension compliance	Cms (mm/N):	0.11
Effective cone diameter	D (cm):	5.4
Effective piston area	Sd (cm²):	22.9
Force factor	BL (N/A):	6.3
Reference Voltage Sensitivity Re 2.83V 1m at 1092 Hz	(dB):	89.0

Magnet and voice coil parameters:

Voice coil diameter	d (mm):	51
Voice coil length	h (mm):	5.5
Voice coil layers	n :	2
Flux density in gap	B (T):	1.0
Total useful flux	Φ (mWb):	0.7
Height of the gap	hg (mm):	4.0
Diameter of magnet	dm (mm):	100
Height of magnet	hm (mm):	15
Weight of magnet	(kg):	0.47

Power handling:

Longterm Max System Power (IEC)	(W):	200
Max linear SPL (rms)/by power	(dB/W):	107/105
Frequency range for test signal:		1000-5000 Hz

Normal programme material signal with a crest factor of 6dB (IEC 268-5) is used in both tests

