



# ST 1308

## Supreme Tweeter, Ø 130mm, 8Ω offset dome



### Features:

- \* Underhung voice coil
- \* Large Hexatech aluminum voice coil
- \* 130 mm offset dome aluminum face plate
- \* Replaceable Acuflex™ dome / coil assembly
- \* Neodymium flat pancake design magnet
- \* High power handling

### SPECIFICATIONS

#### General Data

Overall Dimensions	DxH	130 mm (5.12") x 40mm (1.57")
Nominal Power Handling (DIN)	P	220W/12dB
Transient Power 10ms		1000W
Sensitivity 1W/1M		91.5dB SPL
Frequency Response		1400-22K
Cone/Dome Material		Acuflex™ hand coated soft dome
Net Weight	Kg	0.52

#### Electrical Data

Nominal Impedance	Z	8Ω
DC Resistance	Re	5.2Ω
Voice Coil Inductance @ 1KHz	LBM	0.09mH

#### Voice Coil and Magnet Parameters

Voice Coil Diameter	DIA	28mm
Voice Coil Height		2.7mm
HE Magnetic Gap Height	HE	4.2mm
Max. Linear Excursion	X	
Voice Coil Former		Aluminum
Voice Coil Wire		Hexatech™ Aluminum
Number Of Layers		2
Magnet System Type		Neodymium Flat Pancake
B Flux Density	B	
BL Product	BXL	

#### T-S Parameters

Suspension Compliance	Cms	
Mechanical Q Factor	Qms	
Electric Q Factor	Qes	
Total Q Factor	Qts	
Mechanical Resistance	Rms	
Moving Mass	Mms	
Eq. Cas Air Load (liters)	VAS	
Resonant Frequency	Fs	680 Hz ±10%
Effective Piston Area	SD	6.0 cm <sup>2</sup>

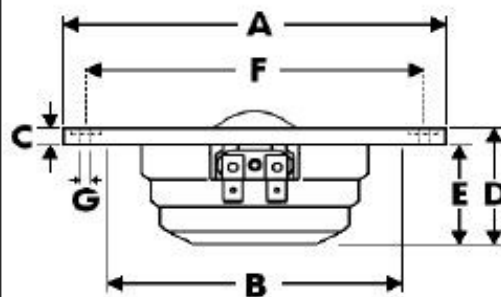
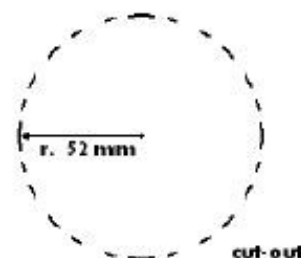

- A - Overall diameter 130mm
- B - Cut out diameter 104mm
- C - Flange thickness 5mm
- D - Overall height 40mm
- E - Magnet/Chamber depth 35mm
- F - Mounting holes location diameter 118mm
- G - 6 Mounting holes, at 60° interval, inner hole diameter Ø 3mm pocket h 1.5mm, Ø 8mm

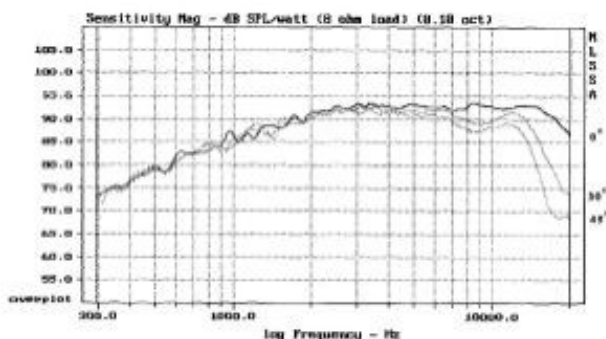
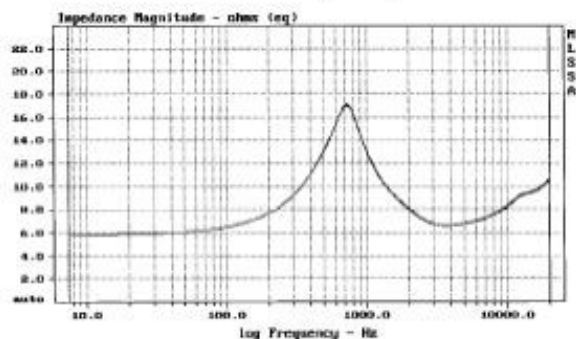

This model replaces former Morel Supreme-130 model.

Morel operate policy of continuous product design improvement, consequently specifications are subject to alteration without prior notice.